

The Power of DRY. **SWEDRY** Carpet Cleaner

TM 15 – MODEL

DRY ORGANIC™
Dry Carpet Cleaning Machine

OPERATOR'S MANUAL

*Please read the Operation's
Manual completely before using
the machine and pay close
attention to the safety advice.*



1-800-DRYCARPET® Systems, Inc.

3419 Via Lido #650

Newport Beach, CA 92663 USA drycarpet.com

Corporate: (888) 379-2277 International: (+01) 714-888-4207

Service: (800) 379-2277

INSTRUCTIONS

Your Swedry® DRY ORGANIC™ Dry Carpet Cleaning machine is designed to give you excellent performance and satisfaction throughout its life. Reading this manual will help you get the most from its features and capabilities. For step by step instructions and video training visit drycarpet.com/machine.

ASSEMBLY

In the shipping box you will find: The machine base (shipped with two standard brushes installed); Renovators (for retrieval of used/dirty Swedry® product granuals), dust covers and two or three pieces that creates the handle (depending on model).

- A.** Place the handle on the bolt and screw both parts together.

[Do not plug in the power cord until assembly is complete]

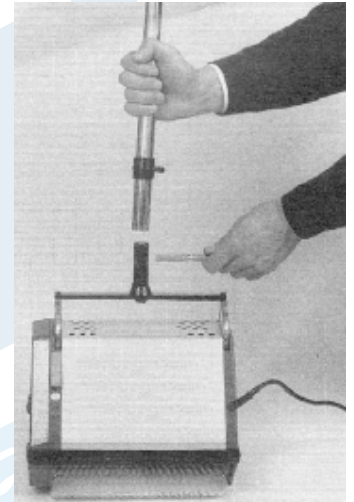

OPERATION

- A.** Plug the power cord into standard 110 volt outlet. Press safety catch on handle. The motor starts when the handle is simply tilted.

NOTE: Please do not start the machine with brushes on carpet. Tilt machine in such a way that the brushes ARE NOT touching the carpet. This will endure long gear life. Fix the electric in the clip provide on the handle. This largely protects it from the rotating brushes.

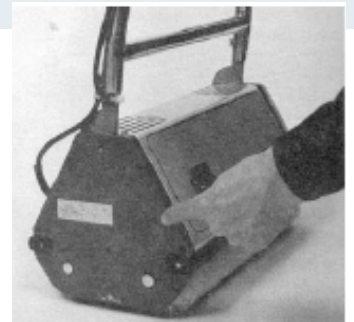

- B.** Motor Safety Switch: The safety switch automatically cuts off the electricity if the motor becomes overloaded. After approximately 30 seconds, press the reset button again and continue operation.

MACHINE OPERATOR'S MANUAL

BRUSH REMOVAL / CHANGING BRUSHES

- A.** Unplug the power cord from the outlet.
- B.** Stand Swedry® DRY ORGANIC™ Carpet Cleaning Machine on its gear side housing (opposite side of the power cord end of machine).
- C.** Pulling out the clips releases the brushes. Reach under with finger and push axles up into the machine. Pull axles straight up and out. No tools are required if the machine is kept clean and the brushes are removed and rotated end-to-end on a regular basis. (Important to note and important to do)

BRUSH SELECTION

GREY: Standard bristle brush: For use on all synthetic fibers; those commonly found in residential and most commercial properties.

WHITE: Medium stiffness - for most carpet types.

BLACK: Soft bristle brush: For use on delicate natural fibers such as; wool, cotton and/or silk and some area rugs. Questions: (888) 379-2277.

BROWN: Aggressive bristle brush: Rarely required and rarely suggested. For use on some commercial carpet; low cut pile and some low looped pile. Use cautiously on heavy soil load and where pile lifting is needed. NOTE: We suggest that you be extremely careful with BROWN Aggressive bristle brushes. Questions: (888) 379-2277.

CAUTION: Swedry® Machine must be unplugged from the power outlet immediately after use and before cleaning and/or exchanging the brushes.

CLEANING & MAINTENANCE (meant to be read)

A. After each use and completion of Swedry® DRY ORGANIC™ Carpet Cleaning Machine Operation it is important to clean and maintain the machine.

B. Tilt the machine to the side and remove both brushes. Remove any Swedry® Carpet Cleaning used granules (cleaning powder) with a small brush or cloth. Rotate brushes every 2-3 hours of operation. This will prolong brush-life and protects against gear damage.

NOTE: Do Not Lubricate Axles – Keep Clean And Dry

C. Replacing the drive-wheels (gears) – Make sure the power cord is unplugged from the power outlet! Take off the side covers. Exchange the damaged clog-wheel. If you need assistance call (888) 379-2277.

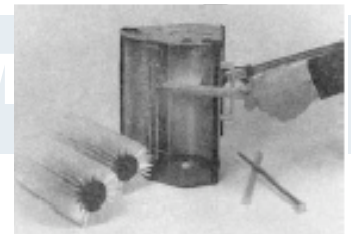

PROBLEM

Q: Machine does not start and makes no noise.

Q: Machine does not start and makes a grunting noise.

Q: Only one brush turns.

Q: Machine turns on when the handle is in upright and locked position

Q: Machine bounces roughly when in use.

SOLUTION

A: Wait 30 seconds if the machine feels warm to the touch. Push the motor protector reset button (located on the side of the machine). Use a small object like a pencil to be sure to press it in far enough. Check the electrical cords and connections for breaks.

A: Tilt machine toward the foot pedal end of the machine and allow the brushes to rotate at full speed before lowering the machine slowly back onto the carpet.

A: One or more gears have stripped and need to be replaced before use. Remember to always start machine on side, never directly on carpet.

A: Replacement of the foot pedal is needed.

A: Inspect the brushes for directional set of scrubbing in one direction too long. Inspect the axles and brush end caps for wear which will cause a vibration.

NOTE: To prevent directional set, rotate both brushes end-to-end. Always perform this action at days end or after 2-4 hours of continuous use.

MACHINE OPERATOR'S MANUAL

MODEL SCHEMATIC

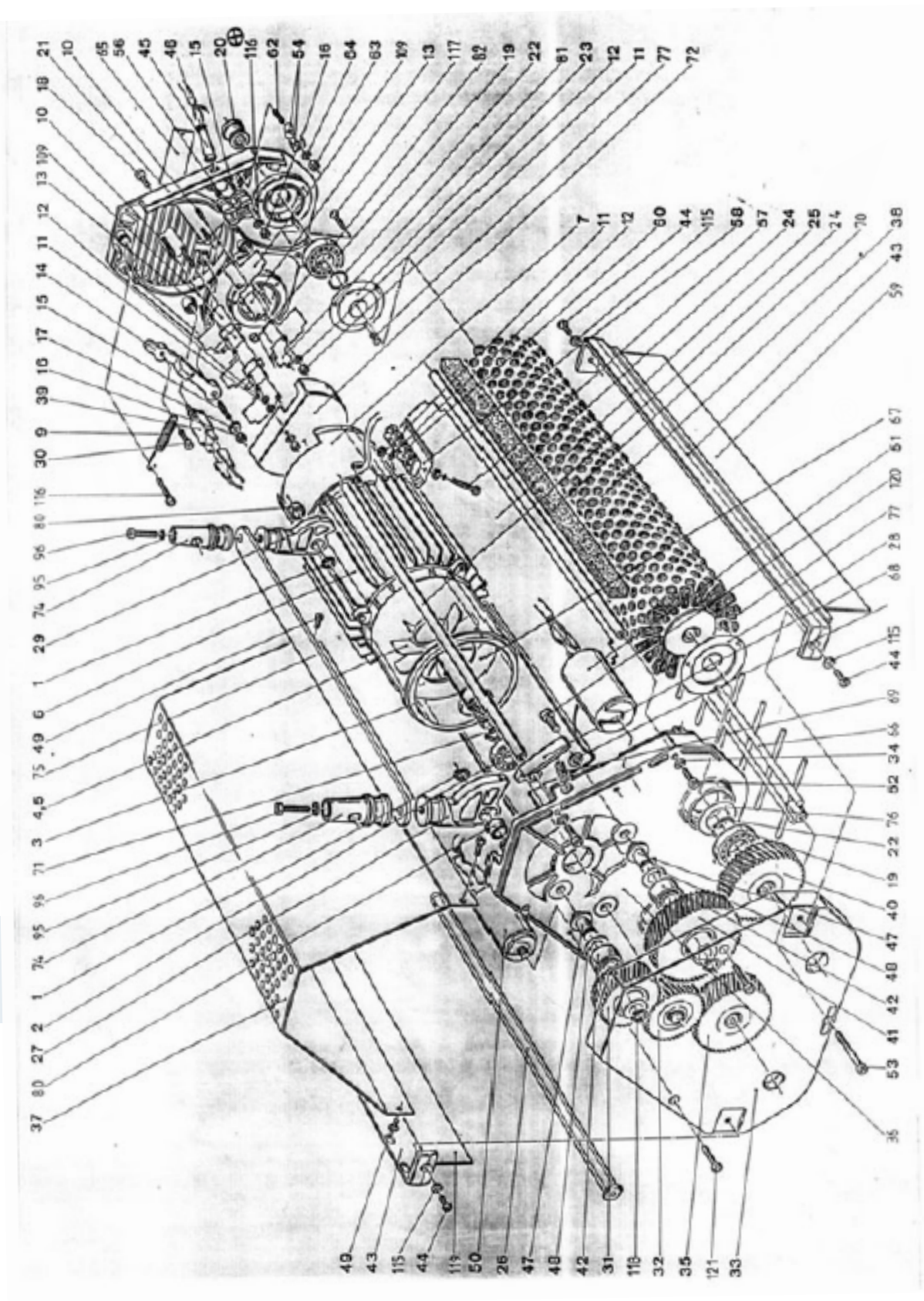

MACHINE PARTS LIST

MACHINE PARTS LIST		MODELS: TM 10 - TM 15 - TM 20	
No:	Description	No:	Description
TM 10:			
1	Snapring A12	43	Sideprotector
2	Ballbearing 6002-2RS	44	Screw M5x12
3	Distancepiece G	45	Grommet
5	Ventilator	46	Cable Schuko 10 m
6	Motor RBF 18/2-7PR	47	Bearingpin
7	Distancepiece E	48	Disc
8	Trolley cpl.	50	Run Capacitor
13	Microswitch		
14	Switchpart	54	Clamp strip
19	Ballbearing 6003-2RS	55	Spring
20	Flange	56	Cable clamp
21	Housing unit E cpl.	60	Terminal EKL1
22	Retainingring A 17	61	V-Ring
23	Protective plat	62	Wormscrew
24	Motorstud	66	Cableprotector
25	Brushcover	68	Handle stop
26	Brush axle	69	Handle stop-spring
27	Handle connector lower part G	70	Seal (Motorcover)
29	Handle connector lower part E	71	Snapring A 15
30	Screw M6x16	72	Swichcover
31	Gear 48 right	74	Handle connector upper part
32	Gear 48 left	75	Flatbar
33	Gearcover	78	Snap-in
34	Lockwasher M 5	82	Rollerleverholder
35	Gear 68 right	83	Cross bar
36	Housing unit G cpl.	84	T-piece left cpl.
39	Thermorelay	85	Cableholder
40	Gear 68 left	86	Tandem-bar
41	Gear 73 right	88	Handle cpl.
42	Ballbearing 6000	120	T-piece right cpl.
		126	Cableholder right
TM 15:		TM 20:	
6-3	Motor RBF 18/2-7PR	6	Motor RBF 18/2-7PR
8-3	Trolley	8	Trolley
24-3	Motorstud	24	Motorstud
25-3	Brushcover	25	Brushcover
26-3	Brush axle	26	Brush axle
31-3	Gear 48 right/TM3	43	Sideprotector/pce.
32-3	Gear 48 left/TM3	66	Cableprotector
43-3	Sideprotector/pce.	75	Flatbar
66-3	Cableprotector	86	Tandem-bar
75-3	Flat bar		
84-3	Plastic handle base		
87-3	Fixing bar for handle		
88-3	Handle, cpl.		

Machine parts, which are not listed in the TM 15/TM20 - spare part list are identical with TM 10 spare parts listed above.

Swedry® DRY ORGANIC™ Dry Carpet Cleaning Machine
15/20 Inch Machine Handle & Trolley

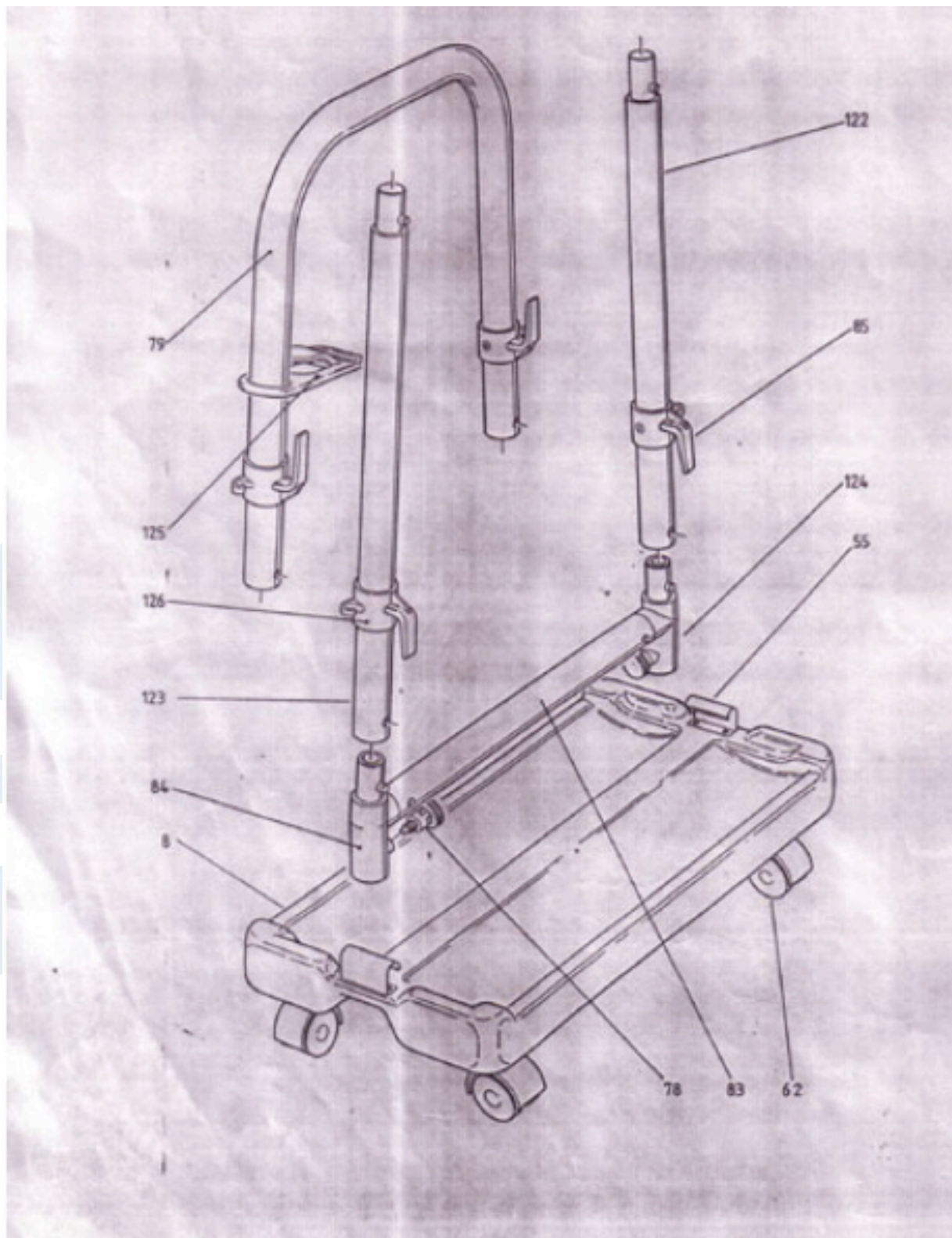

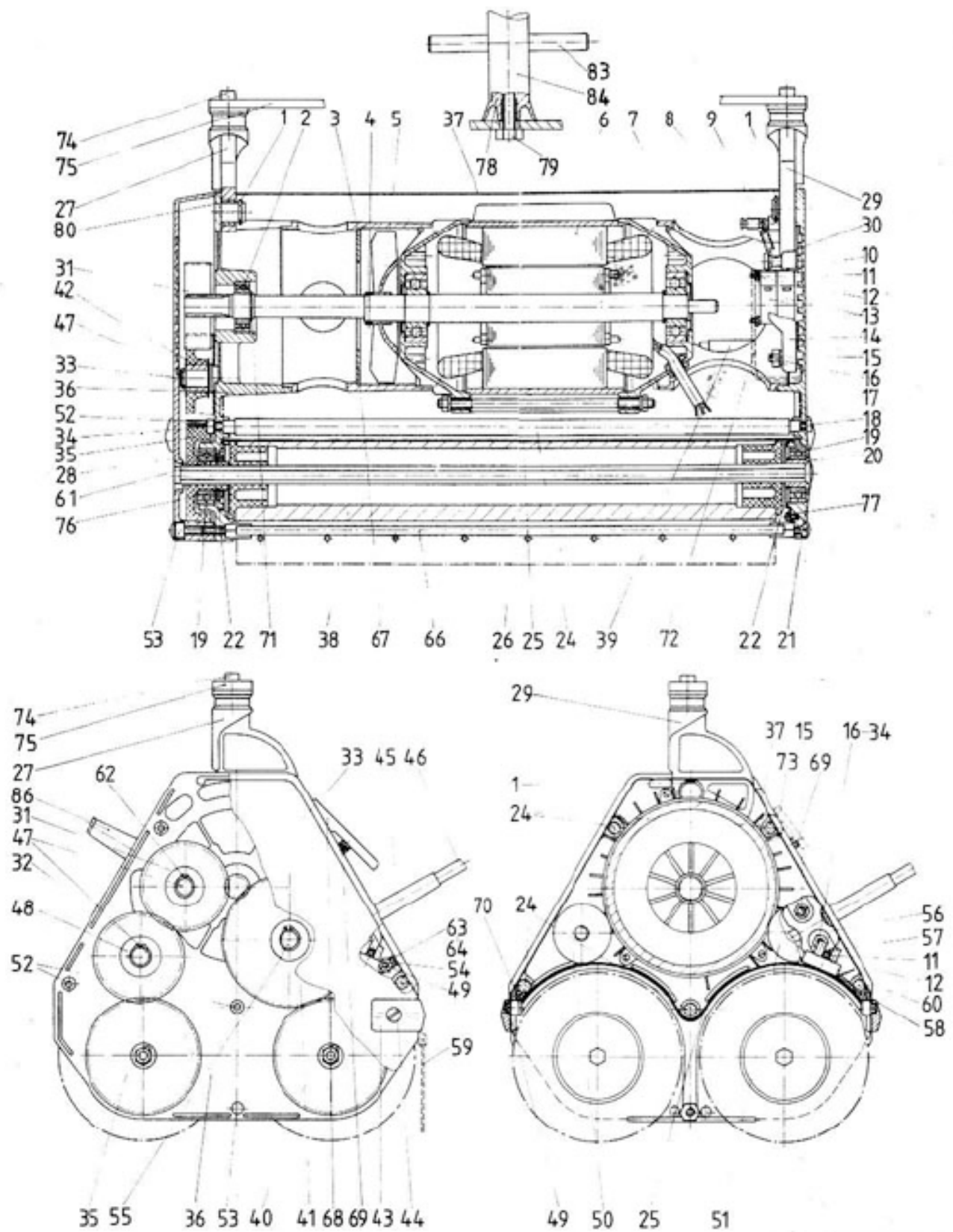

TECHNICAL DETAILS

	TM 10	TM 15	TM 20
MOTOR	440w	1/2hp/800W	
POWER CORD	4' 16AWG with ground		
CORD LENGTH	50' 14AWG extension cord		
BRUSH SPEED	400rpm	480rpm	
WEIGHT	26.46lb.	42.33lb./46.96lb.	
HEIGHT	9.05"	8 ½"	
OVERALL WIDTH	9.21"	9 ½"	
CLEANING WIDTH	10"	15"	20"

For servicing and repairs please contact our service technicians (888) 379-2277.

CAUTIONS – Safety Advice

Electrical: Always disconnect power cord from the wall outlet before changing brushes, maintenance tasks, lifting the machine off the floor or servicing.

KEEP AWAY FROM WATER. Water is not only bad for carpet but its bad for the machine.

Inspect the power cord prior to each use for abrasions or cuts – if cuts are found, prelace the cord before use and handling.

This machine and counter rotating brushes:

Do not run the machine over electrical, telephone or computer cables.

Do not leave the machine plugged into the power outlet when unattended.

Keep children away.

Keep out of reach of children.

Ensure the handle is in its upright position and the lock is working correctly prior to connecting the machine to the power supply.

Do not run the machine over loose carpet fibers or edges of rugs or carpet matting.

Always store the machine in the storage tray/trolley to protect the brushes.

**IT IS THE USER'S RESPONSIBILITY TO OPERATE
THIS MACHINE / APPLIANCE SAFELY AND CAREFULLY.**

1-800-DRYCARPET® Systems, Inc., Does Not Assume any Liability.

1-800
DRYCARPET[®]
The Original DRY ORGANIC™ Company

The Power of DRY.
SWEDRY[®]
Carpet Cleaner

1-800-DRYCARPET Systems, Inc.
3419 Via Lido #650, Newport Beach, CA 92663 USA
Corporate: (888) 379-2277 International: (+01) 714-888-4207 Service: (800) 379-2277
drycarpet.com



Swedry[®] Carpet Cleaner is a product of 1-800-DRYCARPET[®] Systems, Inc.
Always Made in USA

DRY ORGANIC™, Swedry[®] and 1-800-DRYCARPET[®]
are registered trademarks on file with the United States Patent and Trademark Office, Washington DC.